

Argus Eco Ultra

With 4K 8MP resolution, the image quality of Argus Eco Ultra is greatly enhanced. You can see more details in live view or playback, and know exactly what is happening in front of the camera. Supporting both 5/2.4 GHz dual-band WiFi, Argus Eco Ultra gives you more options and more convenience.

1. Specs



1	Built-in Mic
2	Infrared LEDs
3	Lens
4	PIR Sensor
5	Spotlight
6	Daylight Sensor
7	microSD Card Slot
8	Power Switch

9	Speaker
10	USB-C Port
11	Bracket

Status Light

Status Light	Camera Status
Red light	Wi-Fi connection failed
Blue light	Wi-Fi connection succeeded
Blinking	Standby status
On	Working status

2. Setup and Install

Set up the Camera

What's in the Box

Note: The package content may vary and update with different version and platforms, please take the below information only for a reference. And the actual package content are subject to the latest information on the product selling page.

Argus Eco Ultra



Argus Eco Ultra*1



Security Bracket*1



Quick Start Guide*1



Strap*1



Reset Needle*1



Mounting Template*1



Surveillance Sticker*1



Pack of Screws*1



USB-C Cable*1



Mounting Plate*1

Set up the Camera on the App

Please follow the steps below to do initial setup for the battery-powered cameras via Reolink App.

Step 1. Power on the camera. Remember to turn on the power switch on the camera before initial setup except for Argus 2 and Argus Pro. After a startup sound, you will hear a **repeated Ding** sound or a **voice prompt**.

Note: The voice prompt you will hear may be "Welcome to Reolink, please install Reolink app and scan the QR code on the camera" in multilingual versions, or "please run Reolink app, add the camera and set it up".

Step 2. Tap the icon  in the top right corner to start the initial setup.

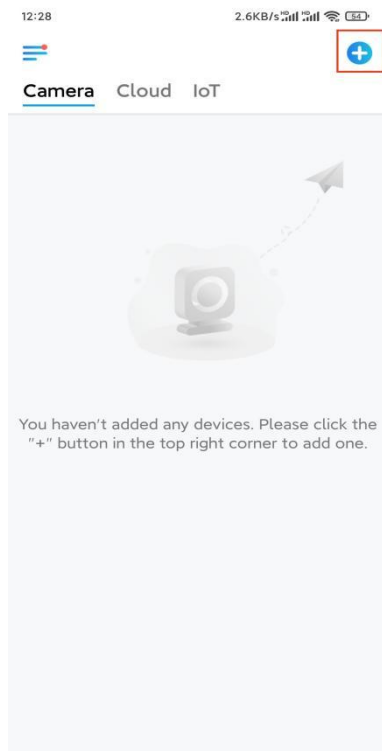

Step 3. Scan the QR code on the back of the camera. You may tap **Light** to enable a flashlight when setting up the camera in a dark environment. If the phone doesn't respond, please tap **Input UID/IP** and then manually type in the UID (16-digit characters under the QR code of the camera). Then click **Next**.

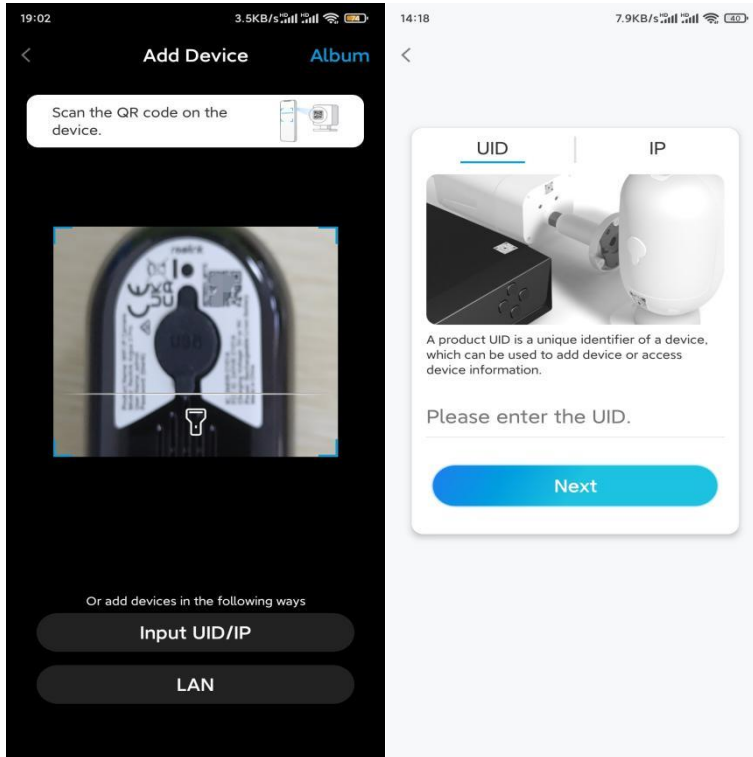

Step 4. Select Wi-Fi Not Configured. If you hear a voice prompt played by the camera, please tick correspondingly and then tap Next.

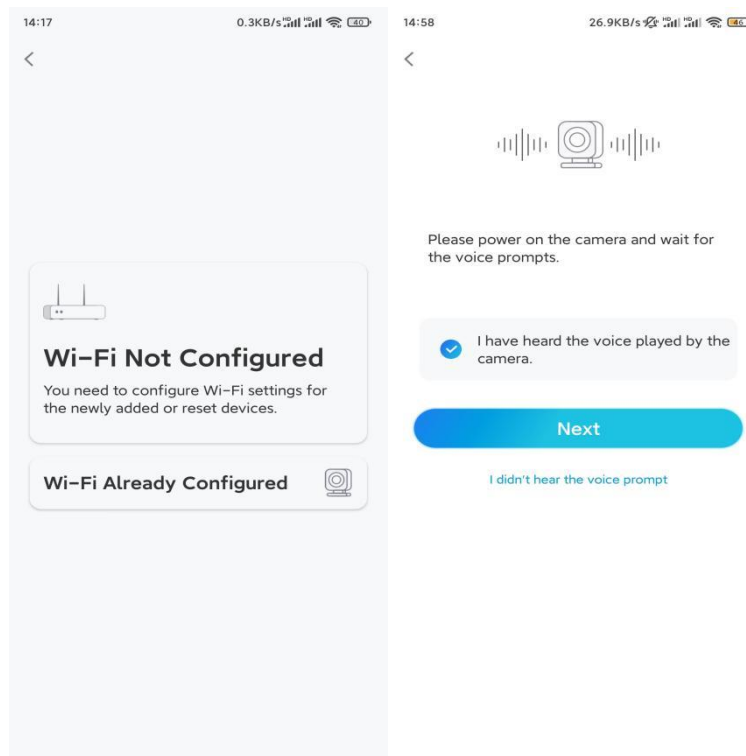

Step 5. Enter the WiFi password of the selected WiFi network (you may tap the right eye icon to see and double-check the password) and tap Next.

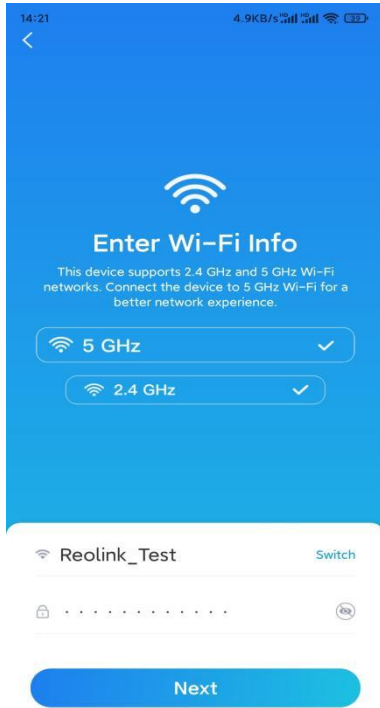

Note: Argus Eco Ultra supports both 2.4GHz/5GHz WiFi networks.

Step 6. Tap **Scan Now**. Place the QR code on your phone in front of the camera's lens at a distance of about 30 cm (12 inches) and let the camera scan the QR code. Tick correspondingly and tap **Next**.

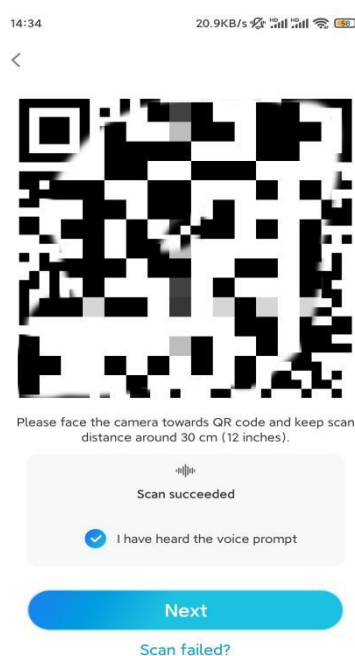
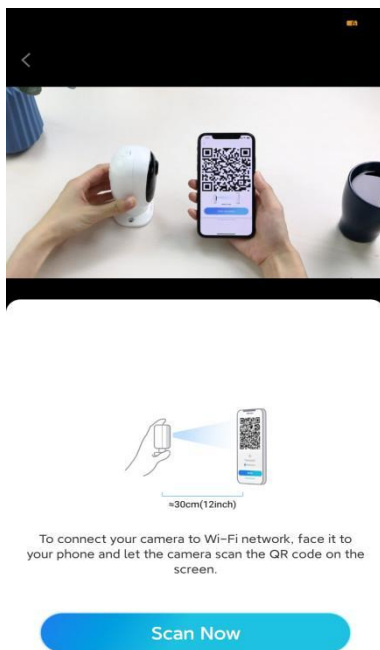

Step 7. Wait around 60 seconds for the camera to connect to the router. After hearing "connection to the router succeeded", tick correspondingly and tap **Next**.



Camera is connecting to the router...



Connection to the router succeeded

I have heard the voice prompt

Next

Connection to the router failed

Step 8. Create a login password and then name your camera.

Device initialization

Device initialization

First step
Create device password
The account info is required when you access device(s) on other platforms. Keep it for quicker access.

Enter password of the device

Please confirm the password

Next

Second step
Name Your Device

Name your camera

Next

Step 9. Read the note below and then tap **Finish** to complete the initialization of your camera.

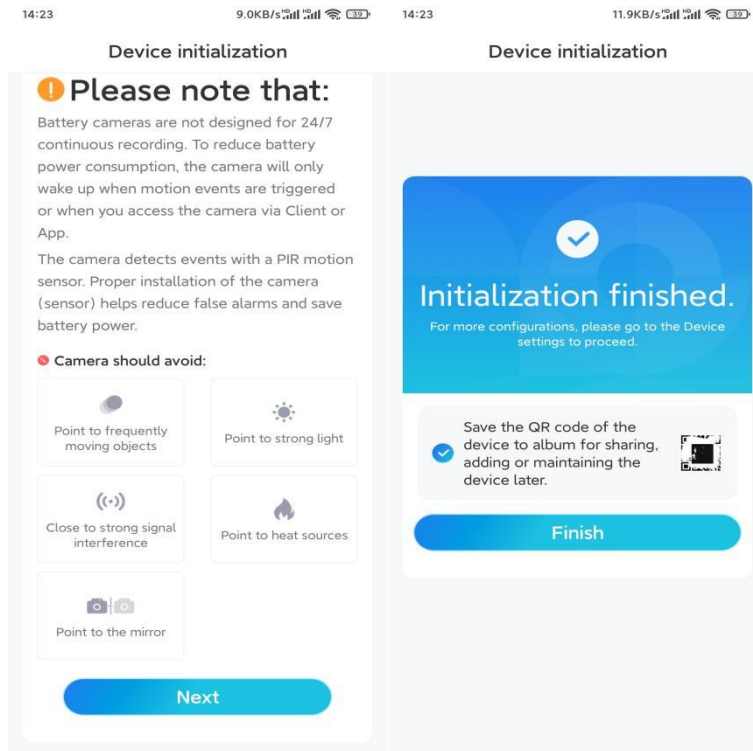

Once the initial setup is completed, you may choose a good position to mount your camera.

Install the Camera

We offer you guides on different scenes in which the camera could be installed. Check out them respectively.

Mount the Camera to the Wall

Step 1. Rotate to separate the base from the bracket.



Step 2. Drill holes in accordance with the mounting template and screw the base of the bracket to the wall. Next, attach the other part of the bracket to the base.

NOTE: Use the drywall anchors included in the package if needed.

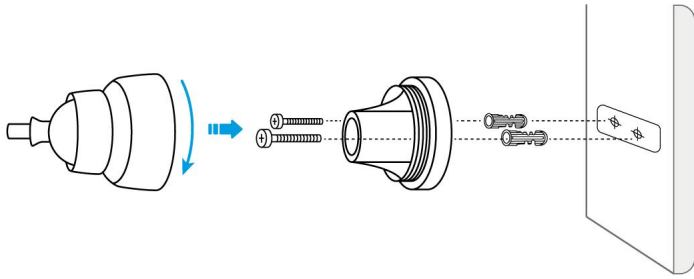

Step 3. Screw the camera to the bracket. Adjust the camera angle to get the best field of view.

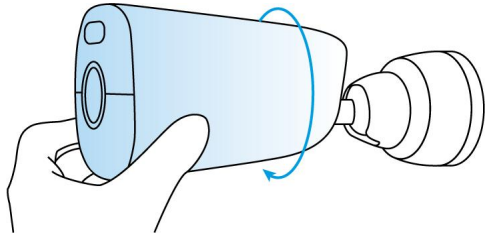

Step 4. Secure the camera by turning the part on the bracket identified in the chart clockwise.

NOTE: To adjust the camera angle later, please loosen the bracket by turning the upper part anticlockwise.

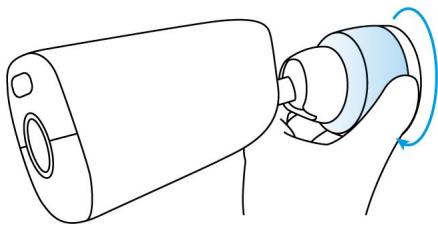

Install the Camera with Loop Strap

Step 1. Secure the bracket's mounting plate to the base with screws.

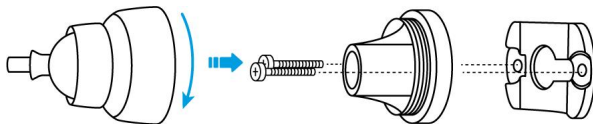

Step 2. Thread the provided strap to the plate and fasten it to a tree. Next, attach the camera to the plate and you are good to go.

